

Comprehensive Urinary Metabolic Profile

BTL001

Read all instructions carefully before beginning

Important information

- Samples must only be collected and shipped Monday, Tuesday or Wednesday.
- The sample must be shipped within 24 hours of collection.

Patient preparation

- Do not collect the sample during menstruation.
- Do not collect the sample during a urinary tract infection.

Procedures, medications and supplements

Invivo do not recommend any changes to prescribed or regular medications / supplements without seeking advice from a suitably qualified medical professional. However, some medications / supplements are known to have an impact on the test results. Please consult your healthcare provider or contact Invivo to discuss any regular medications or supplements.

Restrictive preparation diet

- 48 hours prior to collection, do not consume the following foods:

Beverages:

1. Tea
2. Coffee
3. Alcoholic drinks
4. Juice from the list of fruits or vegetables below

Fruits & vegetables:

1. Avocado
2. Tomato
3. Kiwi
4. Banana
5. Grapes / raisins
6. Pineapple
7. Plums / prunes
8. Plantain

Seeds & nuts:

1. Walnuts
2. Pecans

Other:

1. Ketchup
2. Jelly
3. Vanilla extract
4. Aged and processed cheeses

Preservatives within foods:

1. Sorbic Acid/Sorbate (preservative E200-203)
2. Benzoic Acid/Sodium Benzoate (preservative E 210-213)

- 12 hours prior to collection, avoid excessive water intake.
- On the morning of collection, do not consume food or drink until you have completed the test.

Kit contents

- 1 test requisition form
- 1 urine collection strip
- 1 urine collection cup
- 1 biohazard bag
- 1 unpaid addressed grey mailing bag

Sample collection

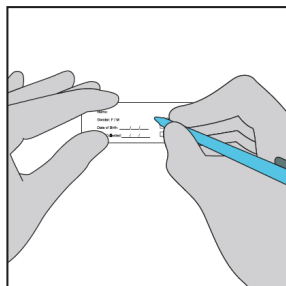

1. Clearly write the following details onto the urine collection strip and the test requisition form:

* Take care not to touch the absorbent pad.*

- Full name
- Date of birth
- Gender
- Collection date

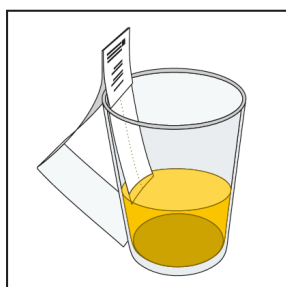

2. Collect urine into the urine collection beaker. Only collect the mid-stream of first morning urine before consuming any food or drink. Do not collect the first portion or urine.

3. Taking care not to touch the absorbent pad, place the absorbent pad into the urine sample. Leave the pad touching the urine sample until fully saturated, or for a minimum of 15 seconds.

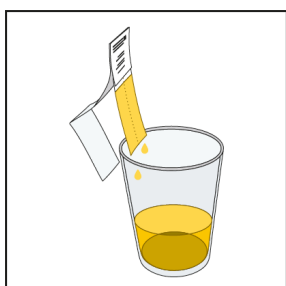

4. Remove the absorbent pad from the sample and allow the excess sample to drip freely into the sample collection cup.

5. The sample must be left to completely dry before shipping. The sample can be air-dried for a minimum of 12 hours; however, humidity and temperature may prolong the drying time. Alternatively, you can use a hair dryer. The dryer must be set to a low temperature setting and held at least 3 inches away from the sample. The sample must not get hot.

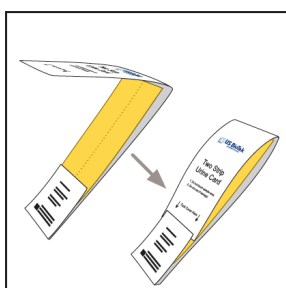

6. Once completely dried, place the protective cover over the absorbent portion of the urine strip and tuck securely.

7. Place the dried and labelled strip into the biohazard bag and seal tightly.

8. Place the biohazard bag and completed test requisition form into the test kit box.

9. Place the test kit box into the unpaid addressed grey mailing bag and organise sample shipping.

Sample shipping**UK:**

Take the unpaid, addressed grey mailing bag to the post office and send "Special Delivery Guaranteed by 1pm" on a Monday, Tuesday, or Wednesday only.

EU:

To arrange sample shipment, contact your local FedEx depot at least 24 hours prior to the collection of your sample.

Ensure the completed test kit is inside the FedEx clinical pack provided. Ensure it is completely sealed with the FedEx shipping documents visible.

Outside the EU:

Arrange an international priority service using a courier of your choice. A FedEx clinical pack is provided if required.

Do not send the sample through the postal service. It is illegal to ship biological samples using the US postal service.

Please contact Invivo ahead of shipping to make them aware of an international delivery.